

SMART DIVIDER™ DEVICE SETUP

1. Activate the sensor
 - a. Cup the sensor in your hand, gripping it by the sides.
 - b. Pull out the tab along the direction of the arrow

A red indicator will blink once after the tab has been removed
2. Provision the sensor
 - a. Log into www.smartdivider.net or the Smart Divider™ app
 - b. Tap on "ADD ITEM"
 - c. (Website) Enter the sensor code or (App) tap on the camera icon to open the scanner and scan the label on the sensor or
 - d. Enter an item description for the item that this sensor will monitor
 - e. Enter the reorder quantity (optional)
 - f. Tap on "SAVE" to finish
3. Select the divider
 - a. Choose the divider that best fits your bin – minimize the gaps between the divider and the bin walls
 - b. Consider where it will be mounted:
 - Near the back if you only have a few items in your safety stock
 - Halfway in if you want an alert when half of your inventory remains
 - c. **Without removing the tape liner**, place it in the bin and move it back and forth to confirm that it is the correct size

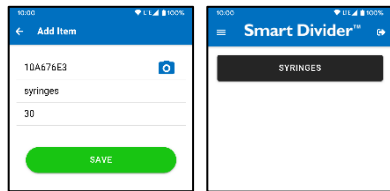
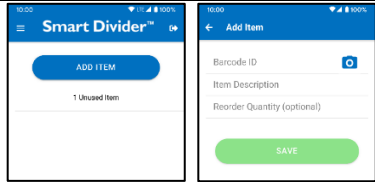

4. Mount the sensor
 - a. Find the label on the back of the divider that indicates where to mount the sensor
 - b. Peel the tape liner from the sensor
 - c. Mount the sensor along the edge of the divider above the label

Arrows on the sensor label and divider label must point in the same direction
5. Attach the divider
 - a. Peel off the tape liner on the bottom of the divider
 - b. Attach the divider to the bottom of your bin in the position you determined in Step 3
Sensor should be facing the back of the bin
 - c. Check the motion of the divider to make sure it clears the bin sidewalls
 - d. Immediately pull the divider out and reattach if the divider hits the bin sidewalls

If your safety stock is pushing forward on the divider, consider using the retainer clip to hold the divider in the **UP** position. The bent wire handle of the retainer clip should face the divider.
6. Confirm your setup
 - a. Move the divider to the **UP** (Full) position – pushing it towards the back of the bin. The color of your item should turn **GREEN** after 30 seconds
 - b. Move the divider to the **DOWN** (Reorder) position – pulling it to the front of the bin. The color of your item should turn **RED** after 30 seconds

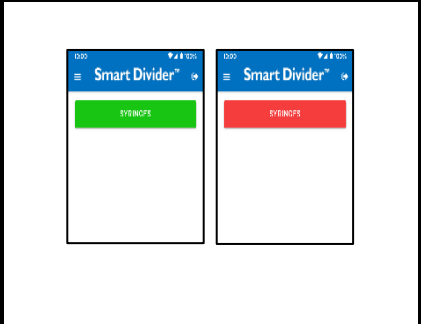
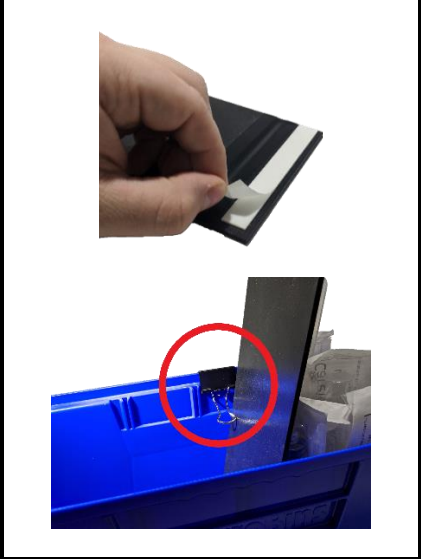

Congratulations! You have successfully configured your Smart Divider™ device!

If you have any issues during setup, please refer to our Troubleshooting Guide at www.smartdivider.net/support or contact us at 414-906-8995.